



' vol. 3 IN/OUTDOOR

TABLE

Structure in anodized honeycomb aluminium, extracted from a single sheet, with no manufacturing waste (016 and 0S2 versions). Modular structure in painted steel sheets (06J and 06U versions).

Code 016: ultralight honeycomb aluminum with black edging for outdoor use

Code 06J: painted sheet steel

Code 06U: sheet steel, painted bronze or white

Code 0S2: ultralight honeycomb aluminum covered with Alpi®

NOTE:

- No-waste tables are delivered unassembled, except code 016.

' vol.3 IN/OUTDOOR

TAVOLO

Struttura in alluminio alveolare anodizzato ricavato da un unico foglio senza alcuno scarto di lavorazione (versioni 016 e 0S2). Struttura componibile in lamiera d'acciaio verniciato (versioni 06J e 06U).

Cod. 016: alluminio ultraleggero, bordo nero per uso esterno

Cod. 06J: lamiera d'acciaio verniciata

Cod. 06U: lamiera d'acciaio verniciata bronzo o bianco

Cod. 0S2: alluminio ultraleggero rivestito in Alpi®

NOTA:

- i tavoli No-waste vengono consegnati smontati, ad eccezione del cod. 016.

Colours 0S2 Colori 0S2



STRIPED BLACK STRIPED WHITE
Alpi® veneer Alpi® veneer

Colours 06J Colori 06J



BLACK STEEL
matt finish

Colours 016 Colori 016



ALUMINIUM
anodized

Colours 06U Colori 06U



COPPER
BROWN
metallic finish



TRAFFIC WHITE
RAL 9003



BLACK
RAL 9005

Table in aluminium

Tavolo in alluminio

016

2,3 m³ 45 Kg

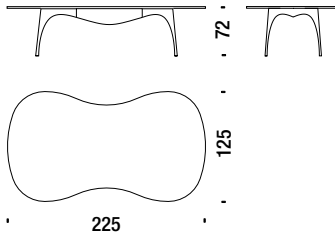

Sheet steel table

Tavolo in lamiera d'acciaio

06J

2,3 m³ 250 Kg

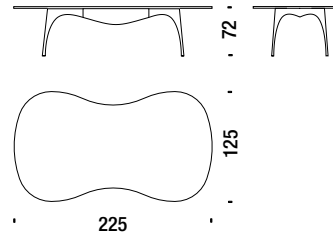
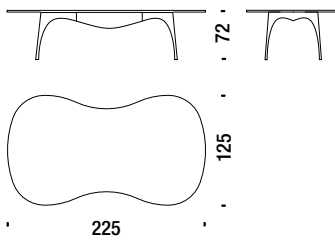

Table varnished

Tavolo verniciato

06U

2,3 m³ 250 Kg



Aluminum table covered with Alpi®

Tavolo alluminio rivestito Alpi®

052

2,3 m³ 60 Kg

