

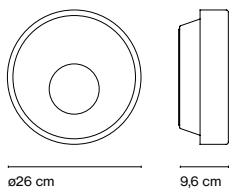

Sun Yonoh

marset

**Sun 26**

ø26 cm

9,6 cm

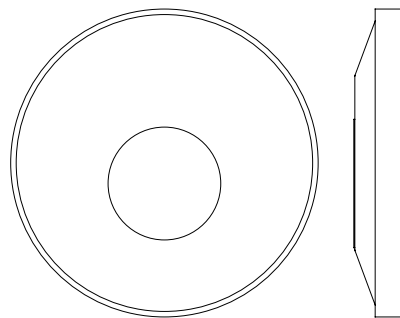
Sun 60

ø60 cm

9,6 cm

The concept of Sun is inspired by the early hours dawn, when the light of the sun plays along the horizon as it begins to appear. Each of Sun's different materials reflects the light in its own way, much as what happens at the exact moment when the night's darkness gives way to the light.

Sun 26

LED 16.2W 700mA 2700K
Light source 1890lm
Luminaire 949 lm
(included)

Sun 60

LED 41W 700mA 2700K
Light source 5176lm
Luminaire 3088lm
(included)

Lacquered iron structure in white or graphite.
Diffuser made of thermoformed opal methacrylate, with another diffuser in opal blown glass placed off-centre.

- White
- Graphite



dimmable

- [Download](#) Assembly instructions
- [Download](#) Energy label
- [Download](#) 2D
- [Download](#) 3D
- [Download](#) Photometric data